

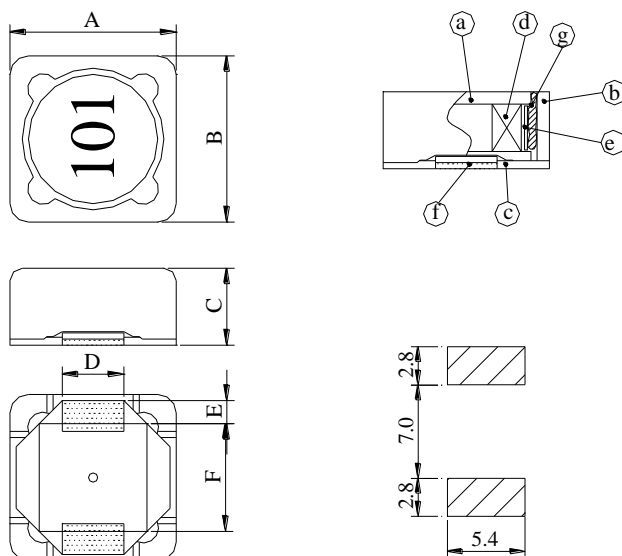

GENERAL COMPONENTS INDUSTRY CORP.

旭誠工業股份有限公司

CONFIGURATION & DIMENSIONS :



SERIES	A	B	C	D	E	F
GSDB1203	12.50±0.3	12.50±0.3	3.90 ^{MAX.}	5.00±0.2	2.20±0.2	7.60±0.2
GSDB1204	12.50±0.3	12.50±0.3	4.60 ^{MAX.}	5.00±0.2	2.20±0.2	7.60±0.2
GSDB1205	12.50±0.3	12.50±0.3	6.00 ^{MAX.}	5.00±0.2	2.20±0.2	7.60±0.2
GSDB1207	12.50±0.3	12.50±0.3	8.00 ^{MAX.}	5.00±0.2	2.20±0.2	7.60±0.2
GSDB1207(Y)	12.50±0.3	12.50±0.3	8.00 ^{MAX.}	5.00±0.2	2.20±0.2	7.60±0.2

UNIT :

m/m

★ MATERIALS :

- a · CORE : FERRITE DR CORE
- b · CORE : FERRITE RI CORE
- c · BASE : LCP E4008
- d · WIRE : ENAMELLED COPPER WIRE 130°C
- e · TAPE : MYLAR TAPE
- f · TERMINAL : TINNED COPPER PLATE
- g · ADHESIVE : EPOXY RESIN

★ GENERAL SPECIFICATION :

- a · TEMP. RISE : 40°C MAX. (GSDB1204,GSDB1205,GSDB1207)
40°C TYP. AT Irms.(GSDB1207(Y))
45°C MAX. (GSDB1203)
- b · RATED CURRENT : BASE ON TEMP. RISE & $\Delta L/L0A=20\%MAX$ (GSDB1203,1204,1205,1207)
 $\Delta L/L0A=10\%TYP.$ AT Isat(GSDB1207(Y))
- c · STORAGE TEMP. : -40°C----+125°C
- d · OPERATING TEMP. : -40°C----+80°C
- e · RESISTANCE TO SOLDER HEAT : 260°C.10 SECS.
- f · INDUCTANCE MEASURING FREQUENCY :
GSDB1203 1R5~331 : 100KHZ , 1V
GSDB1204 3R3~331 : 100KHZ , 1V
GSDB1205 1R5~7R5 : 100KHZ , 1V ; 100~102 : 1KHZ , 1V
GSDB1207 1R2~7R6 : 100KHZ , 1V ; 100~102 : 1KHZ , 1V
GSDB1207(Y) R45~8R2 : 100KHZ , 0.25V ; 100~102 : 10KHZ , 0.25V



GENERAL COMPONENTS INDUSTRY CORP.

旭誠工業股份有限公司

GSDB SERIES II

ITEM	RDC(mΩ) MAX.					IDC(A) MAX.				Isat (A)	Irms (A)
	GSDB1203	GSDB1204	GSDB1205	GSDB1207	GSDB1207(Y)	GSDB1203	GSDB1204	GSDB1205	GSDB1207	GSDB1207(Y)	SGDB1207(Y)
R45					3.2					30.00	14.00
R82					5.0					22.00	12.00
1R2				7.0					9.80		
1R5	13		12		5.9	7.80		8.00		18.00	11.00
2R2	15		14		7.0	6.80		7.00		15.00	10.00
2R7				11.5					8.00		
3R1			17					6.00			
3R3		15			7.9		6.50			11.00	9.00
3R9	26			13.5		5.50			7.50		
4R4			20					5.00			
4R7		18		15.8	9.5		5.70		6.80	10.00	8.50
5R2			21					4.40			
5R6	32			17.6	11.5	4.80			6.60	9.00	8.00
6R8		23			12.5		4.90			8.00	7.50
7R5			24					4.20			
7R6				20.0					5.90		
8R2	45				19.5	4.10				7.30	6.50
100	50	28	25	21.6	20.1	3.90	4.50	4.00	5.40	6.80	6.00
120	60	38	27	24.3	23.2	3.50	4.00	3.50	4.90	6.30	5.60
150	80	52	30	27.0	31.9	3.00	3.20	3.30	4.50	5.80	5.00
180	100	60	34	39.2	35.6	2.70	3.10	3.00	3.90	5.00	4.60
220	110	70	36	43.2	41.0	2.50	2.90	2.80	3.60	4.50	4.30
270	130	80	51	45.9	52.9	2.20	2.80	2.30	3.40	4.00	4.00
330	160	97	57	64.8	59.4	2.10	2.70	2.10	3.00	3.70	3.50
390	180	132	68	72.9	64.8	2.00	2.10	2.00	2.75	3.40	3.30
470	220	150	75	100.0	90.0	1.80	1.90	1.80	2.50	3.20	3.00
560	260	190	110	110.0	115.0	1.60	1.80	1.70	2.35	3.00	2.65
680	310	220	120	140.0	134.0	1.50	1.50	1.50	2.10	2.70	2.35
820	360	260	140	160.0	146.0	1.40	1.30	1.40	1.95	2.40	2.10
101	400	308	160	220.0	156.0	1.30	1.20	1.30	1.70	2.20	2.00
121	530	380	170	250.0	221.0	1.10	1.10	1.10	1.60	2.00	1.90
151	610	520	230	280.0	246.0	1.00	0.95	1.00	1.42	1.80	1.70
181	800	600	290	350.0	324.0	0.90	0.85	0.90	1.30	1.60	1.50
221	970	700	400	390.0	367.0	0.85	0.80	0.80	1.16	1.50	1.40
271	1200	860	460	560.0	425.0	0.75	0.60	0.75	1.06	1.30	1.30
331	1350	980	510	640.0	560.0	0.70	0.50	0.68	0.95	1.20	1.10
391			690	700.0	761.0			0.65	0.88	1.10	1.00
471			770	980.0	855.0			0.58	0.79	1.00	0.95
561			860	1070.0	936.0			0.54	0.73	0.95	0.90
681			1200	1460.0	1296.0			0.48	0.67	0.85	0.80
821			1340	1640.0	1404.0			0.43	0.60	0.80	0.70
102			1530	1820.0	1620.0			0.40	0.55	0.70	0.60

INDUCTANCE TOLERANCE:

GSDB1203 1R5~8R2:Y:±30% , 100~331:M:±20% GSDB1204 3R3~331:M:±20% GSDB1205 1R5~7R5:Y:±25% , 100~102:M:±20%
GSDB1207 1R2~7R6:Y:±30% , 100~470:M:±20% , 560~151:L:±15% 181~102:K:±10% GSDB1207(Y) R45~102:M:±20%