



GENERAL COMPONENTS INDUSTRY CORP.

旭誠工業股份有限公司

GSDC SERIES

Fig:A GSSB0602, GSSB0603, GSSB0604, GSSB0605, GSSB0703, GSSB0705, GSSB1003, GSSB1004

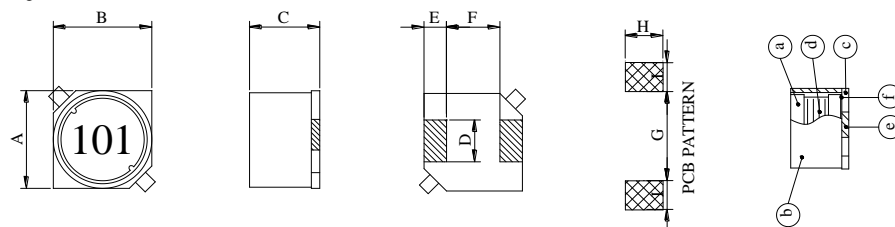
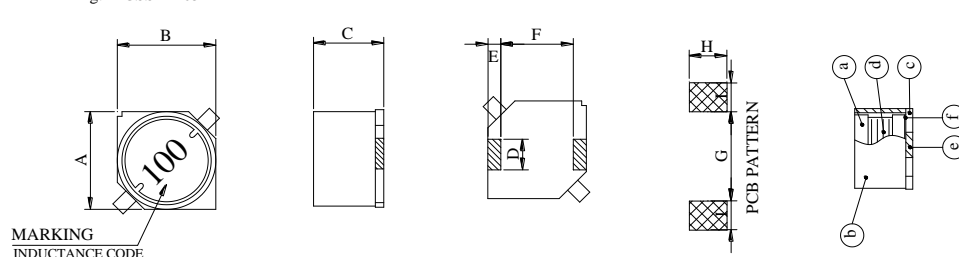

Fig:B GSSB1205



★ GSDC SERIES CONFIGURATION & DIMENSIONS :

SERIES	A	B	C	D	E	F	G	H	I	Fig
GSDC0603	6.2 MAX	6.30±0.3	3.5 MAX.	0.6 TYP.	2.0 TYP.	4.8 TYP.	4.6 REF.	2.6 REF.	1.0 REF.	A
GSDC1003	10.1±0.3	10.0±0.3	3.8±0.2	3.0±0.1	1.5±0.20	7.3±0.3	7.3 REF.	3.2 REF.	1.8 REF.	B
GSDC1005	10.0±0.4	9.0±0.4	5.0±0.5				2.5 REF.	9.5 REF.	5.0 REF.	C

UNIT : m/m

★ MATERIALS :

- a · CORE : FERRITE DR CORE
- b · CORE : FERRITE RI CORE
- c · SLEEVE : PHENOLIC (GSDC1005)
- d · WIRE : ENAMELLED COPPER WIRE 130°C
- e · TERMINAL : TINNED COPPER PLATE (GSDC0603)
Ag+Ni+Sn/Pb (GSDC1003,1005)
- f · ADHESIVE : EPOXY RESIN (GSDC0603,1003)

★ GENERAL SPECIFICATION :

- a · TEMP. RISE : 40°C MAX. AT Irms (GSDC0603)
40°C MAX. AT IDC (GSDC1005)
 - b · RATED CURRENT : $\Delta L / L0A = 30\% \text{ MAX. AT } I_{\text{sat}}$ (GSDC0603)
 $\Delta L / L0A = 35\% \text{ MAX.}$ (GSDC1003)
BASE NO TEMP. & $\Delta L / L0A = 10\% \text{ MAX.}$ (GSDC1005)
 - c · STORAGE TEMP. : -40°C ---- +125°C
 - d · OPERATING TEMP. : -40°C ---- +85°C
 - e · RESISTANCE TO SOLDER HEAT : 260°C, 10 SECS.
 - f · INDUCTANCE MEASURING FREQUENCY :
- GSDC0603 1R0~151 : 100KHZ , 1V GSDC1003 1R5~331 : 100KHZ , 1V
GSDC1005 100~820 : 2.52MHZ ; 101~471 : 1KHZ , 1V



GENERAL COMPONENTS INDUSTRY CORP.

旭 誠 工 業 股 份 有 限 公 司

GSDC SERIES

ITEM	RDC (mΩ)			IDC (A)		Isat (A)	Irms (A)
	TYP.	MAX.	MAX.	MAX.		MAX.	MAX.
	GSDC0603	GSDC1003	GSDC1005	GSDC1003	GSDC1005	GSDC0603	GSDC0603
R80							
1R5		8.1		10.00			
2R0	19.1					2.997	3.30
2R2							
2R5		10.0		7.50			
2R7	22.0					2.691	3.12
3R3	25.7					2.573	2.81
3R8		13.0		6.00			
4R7	31.6					2.084	2.51
5R2		22.0		5.50			
6R2	35.0					1.835	2.41
6R8							
7R0		27.0		4.80			
8R2	43.5					1.542	2.11
100	49.4	35.0	60.0	4.40	2.06	1.491	1.97
120	62.0		70.0		1.94	1.282	1.73
150	77.0	50.0	70.0	3.60	1.72	1.103	1.54
180	81.5		80.0		1.58	1.046	1.52
220	106.0	73.0	80.0	2.90	1.42	0.968	1.29
270	140.0		100.0		1.32	0.821	1.11
330	162.0	93.0	110.0	2.30	1.16	0.755	1.02
390	192.0		120.0		1.10	0.700	0.96
470	209.0	128.0	140.0	2.10	1.00	0.677	0.89
560	257.0		190.0		0.93	0.602	0.80
680	320.0	213.0	210.0	1.50	0.85	0.556	0.71
820	420.0		280.0		0.79	0.468	0.61
101	477.0	304.0	340.0	1.35	0.72	0.449	0.57
121			370.0		0.63		
151	664.0	506.0	510.0	1.15	0.55	0.367	0.48
181			570.0		0.50		
221		756.0	780.0	0.92	0.47		
271			870.0		0.41		
331		1090.0	1200.0	0.70	0.37		
391			1340.0		0.35		
471			1500.0		0.33		
561							
681							
821							
102							

INDUCTANCE TOLERANCE: GSDC0603 2R0~151:M:±20%
 GSDC1003 1R5~331:Y:±30%
 GSDC1005 100~270:M:±20% , 330~820:L:±15% , 101~471:K:±10%