



GENERAL COMPONENTS INDUSTRY CORP.

旭誠工業股份有限公司

GSSB SERIES

★ CONFIGURATION & DIMENSIONS :

Fig:A GSSB0602 , GSSB0603 , GSSB0604 , GSSB0605 , GSSB0703 , GSSB0705 , GSSB1003 , GSSB1004

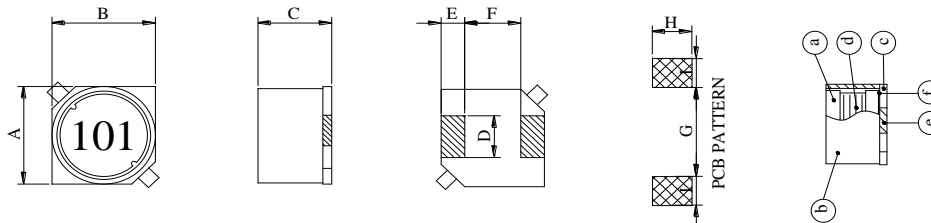
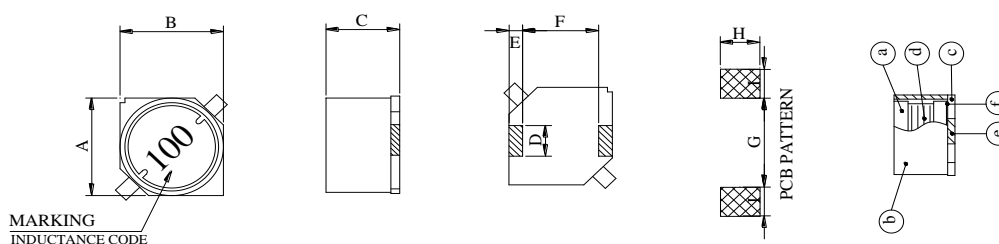

Fig:B GSSB1205



SERIES	A	B	C	D	E	F	G	H	I	Fig.
GSSB0602	6.0±0.3	6.0±0.3	2.5 ^{MAX.}	2.0±0.2	1.5±0.2	3.0±0.2	2.8 ^{REF.}	2.2 ^{REF.}	1.9 ^{REF.}	A
GSSB0603	6.0±0.3	6.0±0.3	2.9±0.3	2.0±0.2	1.5±0.2	3.0±0.2	2.8 ^{REF.}	2.2 ^{REF.}	1.9 ^{REF.}	A
GSSB0604	6.0±0.3	6.0±0.3	3.9±0.3	2.0±0.2	1.5±0.2	3.0±0.2	2.8 ^{REF.}	2.2 ^{REF.}	1.9 ^{REF.}	A
GSSB0605	6.0±0.3	6.0±0.3	4.9±0.3	2.0±0.2	1.5±0.2	3.0±0.2	2.8 ^{REF.}	2.2 ^{REF.}	1.9 ^{REF.}	A
GSSB0703	7.0±0.3	7.0±0.3	3.0±0.3	2.0±0.2	1.5±0.2	4.0±0.2	3.7 ^{REF.}	2.2 ^{REF.}	1.9 ^{REF.}	A
GSSB0705	7.0±0.3	7.0±0.3	4.6±0.3	2.0±0.2	1.5±0.2	4.0±0.2	3.7 ^{REF.}	2.2 ^{REF.}	1.9 ^{REF.}	A
GSSB1003	10.0±0.3	10.0±0.3	3.0±0.3	2.4±0.2	2.0±0.2	6.0±0.2	5.7 ^{REF.}	2.8 ^{REF.}	2.5 ^{REF.}	A
GSSB1004	10.0±0.3	10.0±0.3	4.6±0.3	2.4±0.2	2.0±0.2	6.0±0.2	5.7 ^{REF.}	2.8 ^{REF.}	2.5 ^{REF.}	A
GSSB1205	12.5±0.3	12.5±0.3	5.5±0.3	3.0±0.1	2.0±0.15	8.6±0.3	5.6 ^{REF.}	3.2 ^{REF.}	2.5 ^{REF.}	B

UNIT : m/m

★ MATERIALS :

- a · CORE : FERRITE DR CORE
- b · CORE : FERRITE RI CORE
- c · BASE : LCP E4008
- d · WIRE : ENAMELLED COPPER WIRE 130℃
- e · TERMINAL : TINNED COPPER PLATE
- f · ADHESIVE : EPOXY RESIN

★ GENERAL SPECIFICATION :

- a · TEMP. RISE : 40℃ MAX. AT IDC (GSSB0602, 0603, 0604, 0605, 0703, 0705, 1003, 1004)
TEMP. RISE : 40℃ TYP. AT I_{rms} (GSSB1205)
- b · RATED CURRENT : BASE ON TEMP. RISE & ΔL/L0A=10% MAX.
(GSSB0602, 0603, 0604, 0605, 0703, 0705)
BASE ON TEMP. RISE & ΔL/L0A=10% TYP. AT I_{sat} (GSSB1205)
BASE ON TEMP. RISE & ΔL/L0A=30% MAX. (GSSB1003, 1004)
- c · STORAGE TEMP. : -40℃ ---- +125℃
- d · OPERATING TEMP. : -40℃ ---- +85℃
- e · RESISTANCE TO SOLDER HEAT : 260℃ .10 SECS.
- f · INDUCTANCE MEASURING FREQUENCY : 100KHZ , 1V
- g · Q MEASURING FREQUENCY : 100KHZ , 1V (GSSB0603)



GENERAL COMPONENTS INDUSTRY CORP.

旭誠工業股份有限公司

GSSB SERIES

ITEM	RDC (mΩ) MAX.									IDC (A) MAX.								Q REF.	SRF (MHZ) TYP.	Irms (A) TYP.	Isat (A) TYP.
	GSSB0602	GSSB0603	GSSB0604	GSSB0605	GSSB0703	GSSB0705	GSSB1003	GSSB1004	GSSB1205	GSSB0602	GSSB0603	GSSB0604	GSSB0605	GSSB0703	GSSB0705	GSSB1003	GSSB1004	GSSB0603	GSSB0603	GSSB1205	GSSB1205
1R0	30	19	22	23	26	20				2.50	2.40	2.50	2.70	3.25	3.00			30	190.0		
1R5	35	25	25	26	31	23	22	21		2.30	2.20	2.20	2.30	3.00	2.90	4.00	5.00	30	140.0		
2R2	45	32	30	28	37	26	25	24		2.00	1.90	1.90	1.90	2.55	2.70	3.50	4.50	35	100.0		
3R0							40	26								3.00	4.00				
3R3	70	50	35	35	48	30				1.60	1.50	1.70	1.80	2.40	2.50			35	85.0		
4R7	85	60	50	40	55	36			23	1.35	1.30	1.30	1.40	2.10	2.00			35	65.0	5.30	5.00
5R2							45	30								2.50	3.00				
6R8	120	70	55	45	75	45	60	35	25	1.10	1.20	1.10	1.20	1.90	1.90	2.20	2.50	35	55.0	5.00	4.00
100	170	120	65	60	100	60	70	42	30	0.95	1.00	1.00	1.00	1.50	1.70	2.00	2.20	40	45.0	4.50	3.50
120		130	90	65	120	65	95	50			0.90	0.90	0.90	1.45	1.55	1.90	2.00	40	40.0		
150	240	150	100	70	130	70	120	55	38	0.75	0.80	0.80	0.80	1.20	1.45	1.70	1.80	35	38.0	4.00	2.80
180		160	110	95	160	80	130	60			0.75	0.70	0.70	1.15	1.20	1.55	1.70	35	35.0		
220	330	230	150	110	190	90	180	80	46	0.65	0.65	0.65	0.65	1.05	1.15	1.45	1.50	40	26.0	3.50	2.30
270		250	170	120	240	120	200	85			0.60	0.60	0.60	1.00	1.00	1.30	1.20	40	24.0		
330	480	340	220	165	300	135	210	110	60	0.50	0.55	0.55	0.55	0.90	0.90	1.10	1.15	45	22.0	3.20	1.90
390		380	240	180	340	150	270	120			0.52	0.50	0.48	0.80	0.85	1.00	1.10	45	20.0		
470	650	420	300	200	400	170	300	150	85	0.40	0.50	0.47	0.45	0.75	0.80	0.85	1.00	45	19.0	2.50	1.60
560		570	340	255	550	230	400	160			0.48	0.42	0.40	0.68	0.70	0.80	0.90	45	17.0		
680	870	620	390	285	650	270	440	190	110	0.30	0.45	0.40	0.37	0.65	0.65	0.75	0.85	50	14.0	2.20	1.30
820		900	500	390	720	300	490	210			0.40	0.35	0.35	0.60	0.57	0.65	0.80	50	13.0		
101	1500	990	570	420	820	360	670	300	150	0.25	0.35	0.32	0.30	0.50	0.50	0.60	0.70	50	12.0	1.80	1.10
121		1150	630	470	1100	400	740	330			0.30	0.30	0.28	0.48	0.47	0.55	0.65	50	11.0		
151	2300	1750	900	630	1300	530	790	360	240	0.20	0.28	0.27	0.25	0.45	0.40	0.50	0.55	50	9.0	1.40	0.90
181		1950	990	720	1500	600	1200	510			0.26	0.25	0.22	0.38	0.38	0.45	0.50	55	8.0		
221	3200	2200	1150	820	2100	800	1350	560	350	0.18	0.22	0.22	0.20	0.35	0.35	0.40	0.45	55	7.5	1.20	0.72
271		2500	1550	1100	2400	900	1800	700			0.20	0.20	0.18	0.30	0.32	0.38	0.40	55	7.0		
331	4800	3200	1760	1200	3100	1000	2000	760	500	0.16	0.18	0.18	0.17	0.28	0.30	0.32	0.37	55	6.0	1.00	0.60
391		3500	2600	1700	4100	1400	2100	1050			0.17	0.17	0.16	0.25	0.27	0.30	0.32	55	5.5		
471	7200	4950	3000	1900	4400	1600	3500	1100	710	0.13	0.16	0.16	0.14	0.23	0.25	0.28	0.30	55	5.0	0.88	0.50
561		5350	3300	2150	5100	1750	3900	1250			0.15	0.15	0.13	0.20	0.22	0.25	0.28	55	4.8		
681	10000	6300	3700	3300	7100	2500	4100	1700	1000	0.11	0.14	0.13	0.12	0.18	0.20	0.22	0.24	55	4.5	0.73	0.43
821		8200	4900	3650	7900	2800	4550	1900			0.13	0.12	0.11	0.17	0.19	0.20	0.23	55	4.0		
102	15500	9200	5700	4150	9000	3200	5100	2150	1450	0.09	0.12	0.11	0.10	0.16	0.18	0.18	0.22	55	3.5	0.60	0.35
152									2100											0.48	0.29

INDUCTANCE TOLERANCE: GSSB0602 1R0~102:M:±20%
 GSSB0604 1R0~102:M:±20%
 GSSB0703 1R0~102:M:±20%
 GSSB1003 1R5~102:M:±20%
 GSSB1205 4R7~152:M:±20%

GSSB0603 1R0~102:M:±20%
 GSSB0605 1R0~102:M:±20%
 GSSB0705 1R0~102:M:±20%
 GSSB1004 1R5~102:M:±20%